

Result of the Bansbach lockable gas spring configuration:

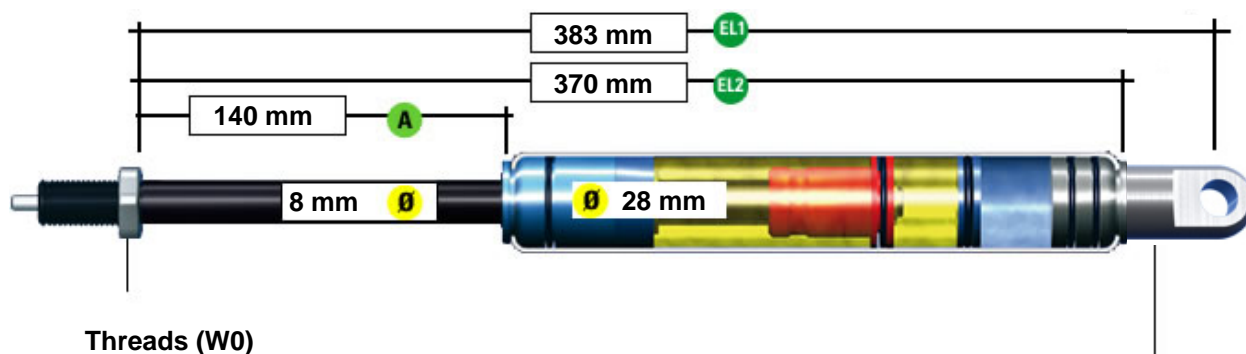

Order number
W0V2K-E-140-383--0XX 40N

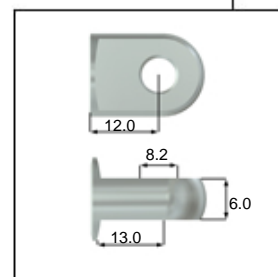

W0	V2	K	-	E	140	383	0XX	40N
----	----	---	---	---	-----	-----	-----	-----

07.08.2017

Gas spring

Extension-force: **40 N** Stroke: **140 mm**
 Diameter: **8/28** Model: **K**
 Push-out speed: **normal** Release travel: **normal**
 Connecting part piston rod: **Threads (W0)** Connecting part cylinder: **(V2)**

Extended length EL2: **370 mm**
 Extended length EL1: **383 mm**

The total length is calculated when the piston rod is extended. Length tolerance: +/- 2mm. The shown length is the minimum length.

Release system

Release system:

Number of pieces:

Contact

Company:

Name:

Street:

Zip-Code/City:

Message

Country:

Fon:

E-Mail: