

REPAIR PARTS KITS

DESCRIPTION	PART NO.
DIAPHRAGM & SEALS KIT CONSISTS OF ITEM NOS 3,4,7,8,9,14,16,18	1070319 (534-RAF) EPTDM INCLUSES 1073333 (V534-100)
INT. PARTS KIT CONSISTS OF ITEM NOS 3,4,7,8,9,14,16,18	1070327 (534-RAJ) BUTYLE INCLUSES 1073333 (V534-100)
ASSEMBLY TOOLS	1070343 (K534-RF)
LIMIT STOP TOOL (TOOL NOT SHOWN)	1073556 (V560-579)
STRAP WRENCH (TOOL NOT SHOWN)	1073557 (V560-581)

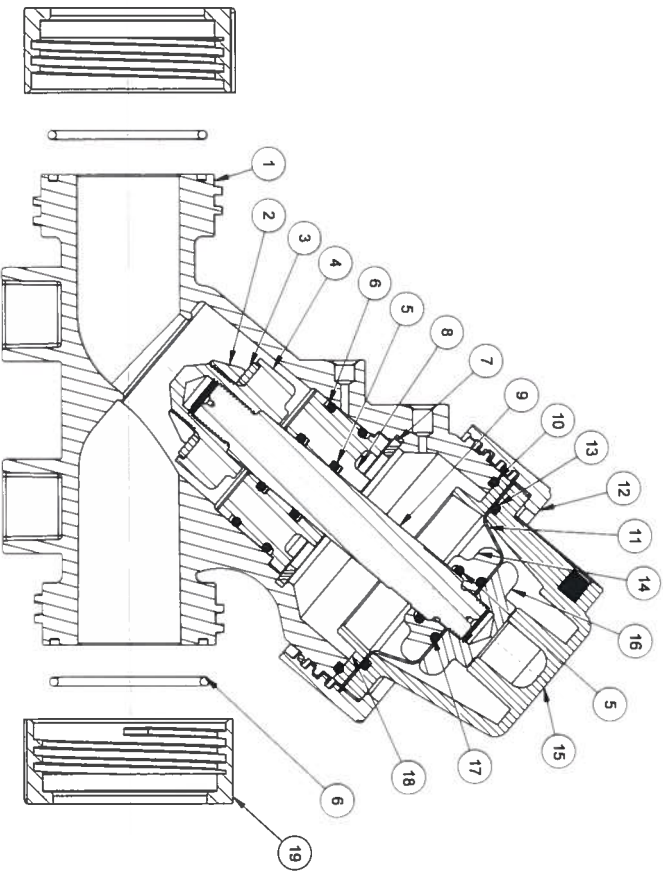
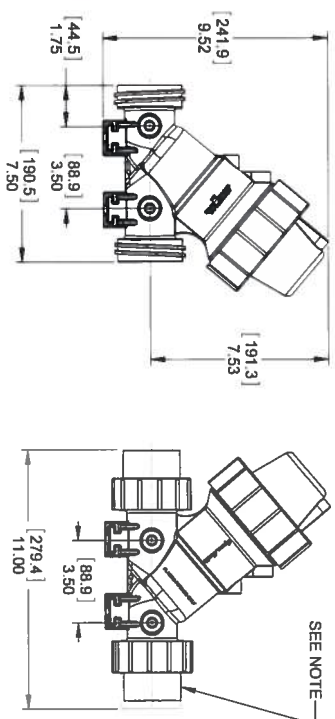

1070308 (K534-X200-14000)
NORMALLY OPEN (STANDARD)

REVISIONS

ZONE	ECN	REV	DESCRIPTION	DATE	APPD
	20989	F	REWORKED DRAWING NUMBER 1073333 TO REFLECT THE NEW CAP DESIGN. THE NEW DRAWING NUMBER IS 1073333. THE OLD DRAWING NUMBER IS 1073333. THE NEW DRAWING NUMBER IS 1073333.	04/05/10	TJM
	33909	G	1 NEW CAP DESIGN PART NUMBER STAYS THE SAME	11-9-11	TMS
	102742	H	REPLACED DRAWING NUMBER WITH FORM NUMBER. UPDATED TABLES.	11/15/13	TJM
	130461	J	SEE EGM FOR LIST OF WHAT CHANGED TO SHOW CORRECT PARTS NO. BOM CHANGES MADE	04/JUN/14	TJM
	105004	K	1/1 ITEM#11 - REMD. 107334, 2/KIT#1070333 WAS 1073334 DIAPHRAGM.	11NOV15	TJM

ITEM NO.	DESCRIPTION	MATERIAL	PART NUMBER	QTY.
1	BODY	PVC	1073344 (V534-410K)	1
2	DISC PLATE	EPDM	1073330 (V534-093)	1
3	DISC	BUTYL	1073337 (V534-110)	1
4	DISC HOLDER	FKM	1073339 (V534-112)	1
5	O-RING	EPDM	1073353 (V534-500)	3
6	O-RING	BUTYL	1071745 (ORE-212)	4
7	RETAINING RING	FKM	1071816 (ORV-212)	1
8	SHAFT GUIDE	PVC	1071751 (ORV-228)	1
9	SHAFT	PVC	1071822 (ORV-228)	1
10	O-RING	BUNA N	1073375 (V534-593)	1
11	DIAPHRAGM	BUNA N	1073350 (V534-491)	1
12	CAP RETAINER NUT	BUNA N	1073360 (V534-533)	1
13	O-RING	FKM	1071709 (ORV-240)	1
14	LOWER DIA. PLATE	PVC	1073333 (V534-100)	1
15	CAP	PVC	1073458 (V537-080K)	1
16	UPPER DIA. PLATE	PVC	1071707 (ORV-235)	1
17	O-RING	BUNA N	1073320 (V534-045)	1
18	DIAPH. SUPPORT	BUNA N	1073317 (V534-020K)	1
19	SOCKET RING NUT	BUNA N	1073318 (V534-040)	1
			1076766 (ORV-214)	1
			1073366 (V534-551K)	1
			1073329 (V534-080K)	2

SEE PAGE 2 FOR CONFIGURATION OPTIONS
NOTE:
CONNECTORS NOT FURNISHED
WITH VALVE.
SEE FORM NO. BR1078165 (DWG. 1084006)
FOR FEMALE SOCKET WELD CONNECTORS.

THIS DOCUMENT IS THE PROPERTY OF AQ Matic. IT IS TO BE USED ONLY FOR THE PROJECT AND LOCATION SPECIFICALLY IDENTIFIED IN THE TITLE. IT IS NOT TO BE REPRODUCED OR TRANSMITTED IN ANY FORM OR BY ANY MEANS, ELECTRONIC OR MECHANICAL, INCLUDING PHOTOCOPYING, RECORDING, OR BY ANY INFORMATION STORAGE AND RETRIEVAL SYSTEM. WITHOUT THE WRITTEN PERMISSION OF AQ Matic, THIS DOCUMENT IS NOT TO BE USED FOR ANY OTHER PROJECT OR LOCATION. THE USER OF THIS DOCUMENT IS RESPONSIBLE FOR OBTAINING ALL NECESSARY PERMITS AND APPROVALS FROM THE APPROPRIATE AUTHORITIES. THE USER OF THIS DOCUMENT IS RESPONSIBLE FOR OBTAINING ALL NECESSARY PERMITS AND APPROVALS FROM THE APPROPRIATE AUTHORITIES. THE USER OF THIS DOCUMENT IS RESPONSIBLE FOR OBTAINING ALL NECESSARY PERMITS AND APPROVALS FROM THE APPROPRIATE AUTHORITIES.

DRAWN: ANH
 DATE: 11/13/13
 APPROVED: [Signature]
 TITLE: CATALOG SHEET, 534
 SIZE: B
 DWG NO: 1077689
 SCALE: 1:2
 SHEET 1 OF 2

AQ Matic
 Valve & Control Company Inc.